

# FUEL SYSTEM

## CONTENTS

<b>FUEL TANK / FUEL COCK</b> .....	<b>4- 1</b>
<b>FUEL PUMP</b> .....	<b>4- 2</b>
<b>CARBURETOR</b> .....	<b>4- 3</b>

### CAUTION

Gasoline must be handled carefully in an area well ventilated and away from fire or sparks.

## FUEL TANK / FUEL COCK

### ⊙ REMOVAL

#### ⚠ WARNING

Gasoline is very explosive. Extreme care must be taken.

- Remove the front seat. (Refer to page 7-1)
- Remove the fuel tank mounting bolt, and take off the hooks.
- Disconnect the fuel hose ① and remove the fuel tank.

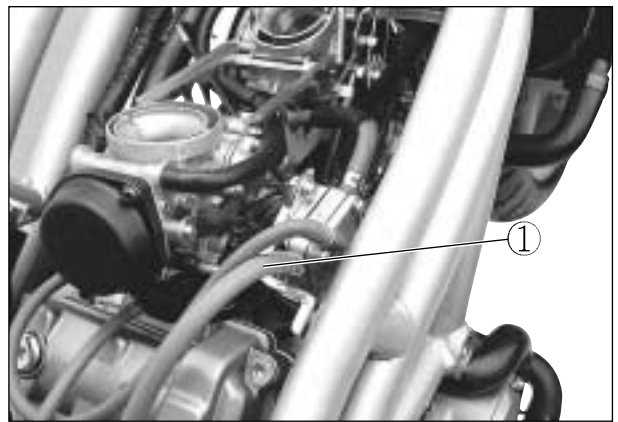

- Remove the fuel cock.



### ⊙ INSPECTION

#### ■ FUEL COCK

If the fuel filter is dirty with sediment or rust, fuel will not flow smoothly and loss of engine power may result.

Clean the fuel filter.

Also check the fuel cock for cracks.

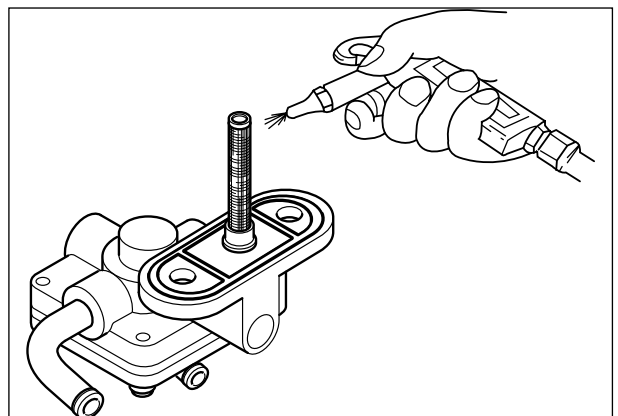

### ⊙ REMOUNTING

Remount the fuel tank and fuel cock in the reverse order of removal.

#### ⚠ CAUTION

- Gaskets ① and ② must be replaced with new ones to prevent fuel leakage.
- Tighten the fuel cock bolts evenly.

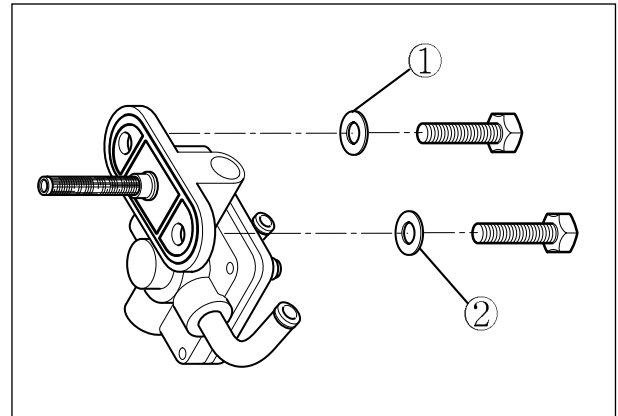

## FUEL PUMP

### ⊙ REMOVAL

- Remove the front seat and fuel tank.
- Disconnect the fuel hoses ③, ④ and vacuum hose ⑤.

### ⊙ INSPECTION

#### ⚠ WARNING

Gasolin is very explosive. Extreme care must be taken.

- Disconnect the fuel hose ③, connect the suitable hose and insert the free end of the hose into a receptacle.

Check the fuel flow when starting the engine for a few seconds by pressing the starter switch.

If the fuel flow is not found, check the fuel cock. (Refer to page 4-1)

If the fuel cock and hoses are not fault, replace the fuel pump.

### ⊙ REASSEMBLY

Carry out the assembly procedure in the reverse order of disassembly.

- Tighten the fuel pump mounting bolts.
- Connect the fuel hoses ③, ④ and vacuum hose ⑤ securely.

#### FUEL HOSE ROUTING :

Fuel hose ③ (To carburetor)

Fuel hose ④ (To fuel cock)

Vacuum hose ⑤ (To carburetor vacuum pipe).

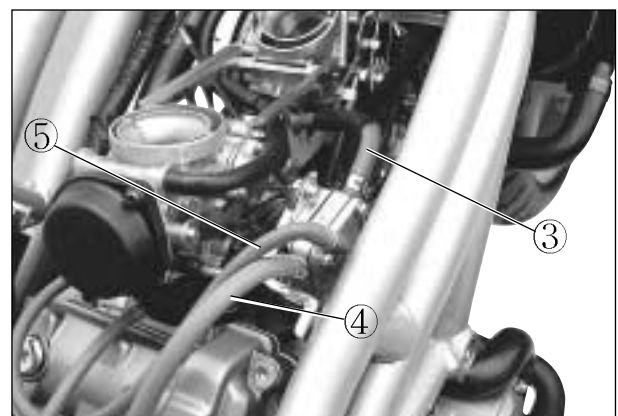
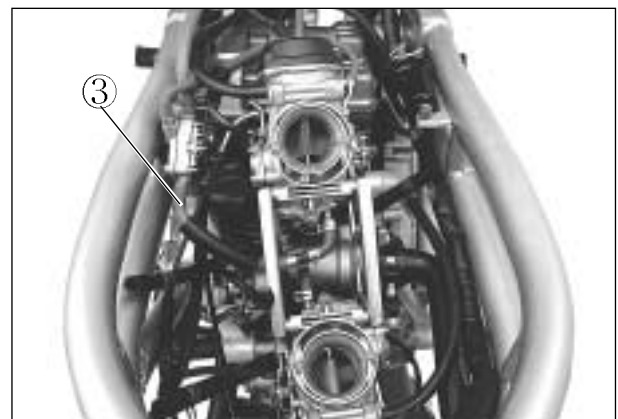

# CARBURETOR

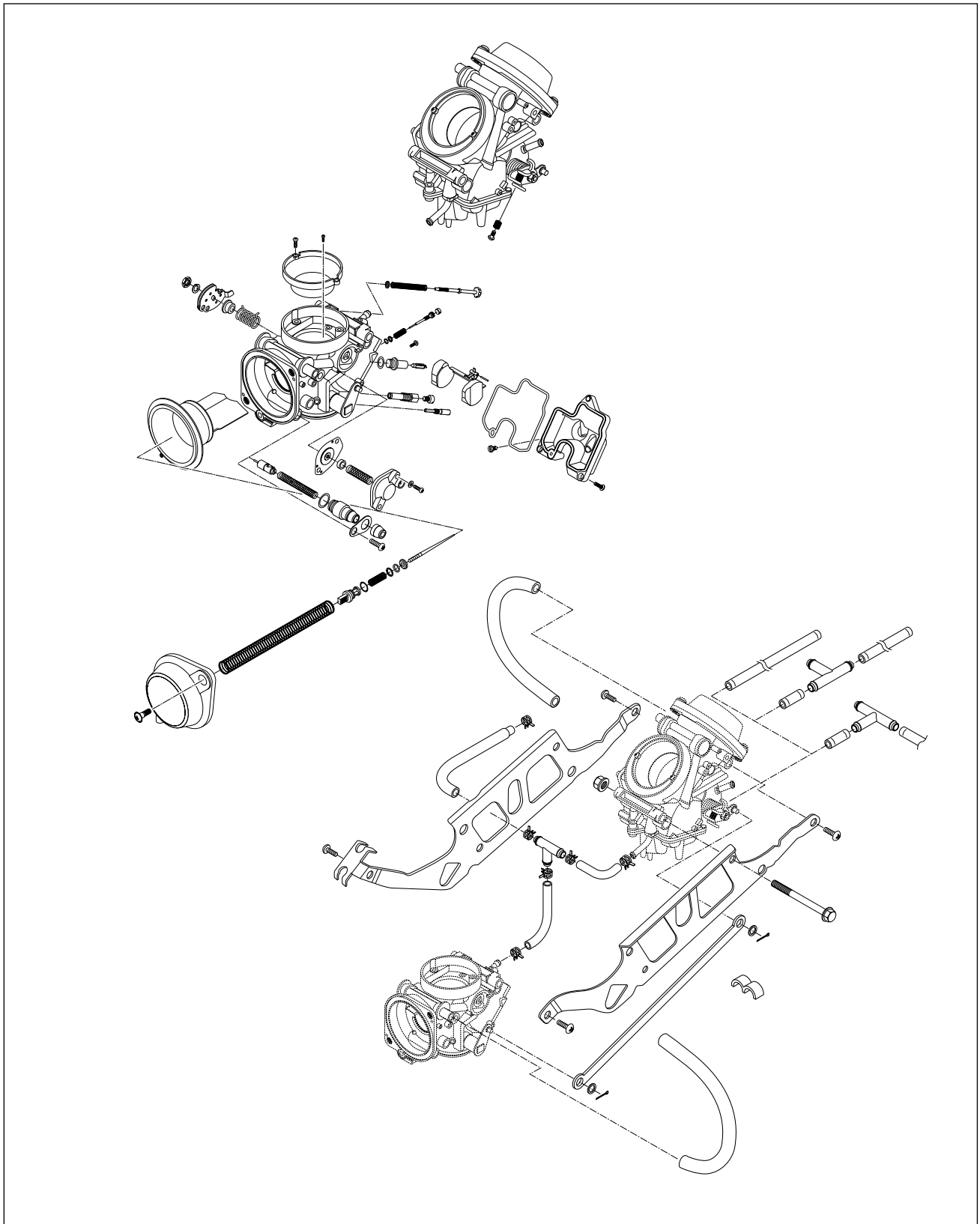

⊙ **LOCATION OF CARBURETOR I.D. NO.**

The carburetor I.D. is stamped on the location on the carburetor as shown in the right photo.

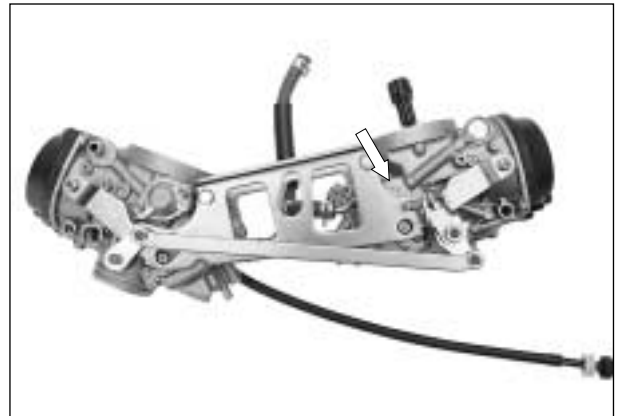

⊙ **REMOVAL**

- Remove the fuel tank. (Refer to page 4-1)
- Remove the fuel hose.



- Remove the throttle cables ① and choke cable.
- Loosen the clamp screw and remove the carburetor.



⊙ **DISASSEMBLY**

- Remove the diaphragm cover ②.

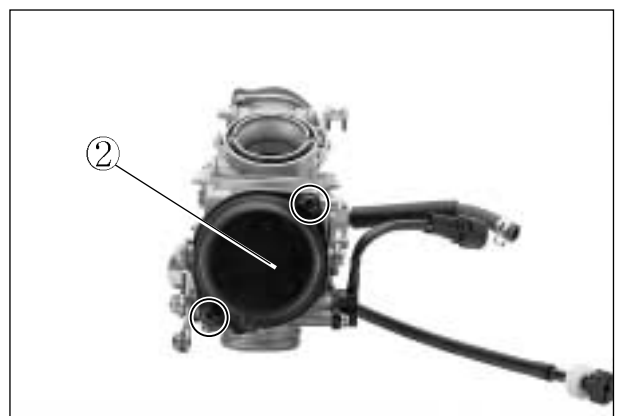

## 4-5 FUEL SYSTEM

---

- Remove the spring ① along with diaphragm ②.

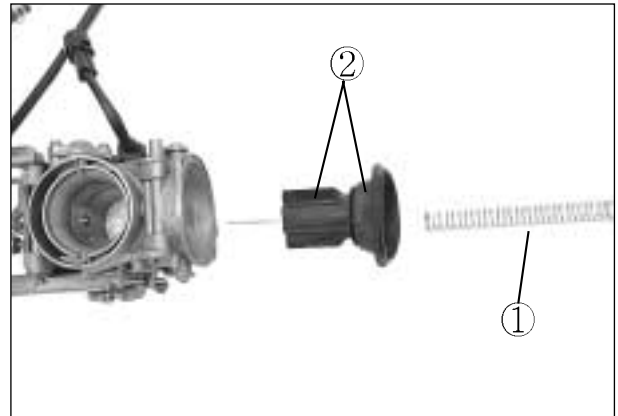

- Remove the jet needle cap ③, spring ④, retainer ⑤, and jet needle ⑥.

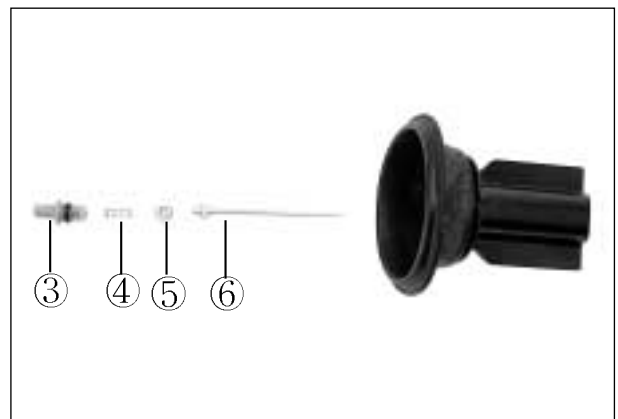

- Remove the float chamber body ⑦.

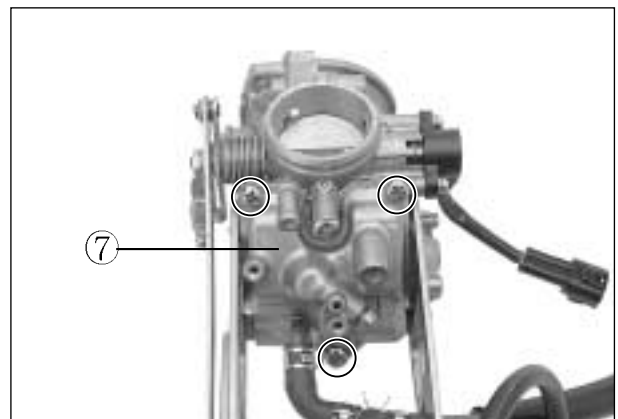

- Remove the float assembly ⑨ along with the needle valve ⑧ by removing the pin.

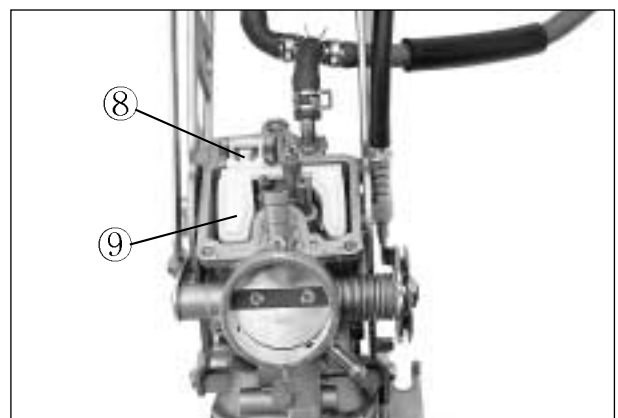

- Remove the valve seat ①.
- Remove the main jet ②, jet holder ③ and pilot jet ④.

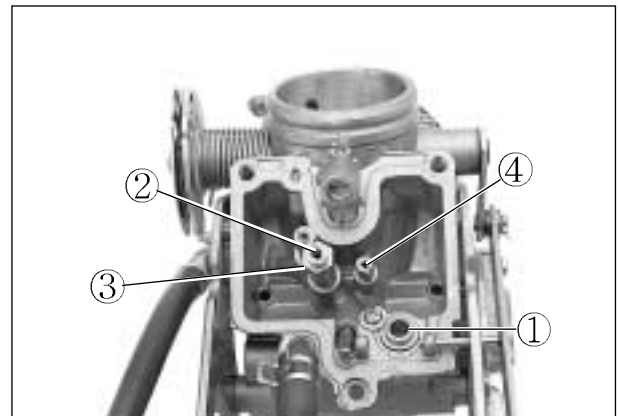

- Remove the pilot screw ⑤ counting and tightening the number of turn.

**NOTE**

*Record the number of turn for the pilot screw when install to confer.*

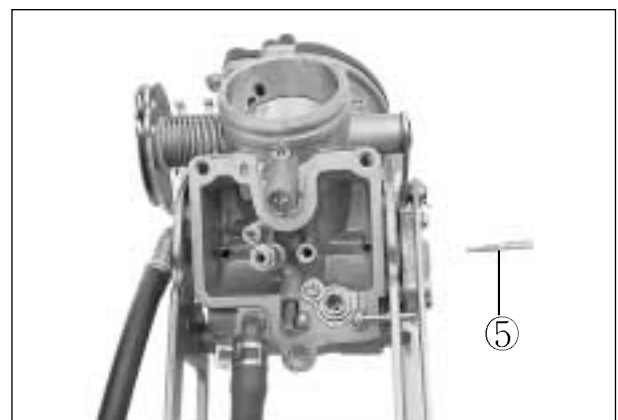

⊙ **INSPECTION**

Check the following parts for damage and clogging.

- |                     |                           |
|---------------------|---------------------------|
| · Pilot jet         | · Piston valve            |
| · Main jet          | · Starter jet             |
| · Main air jet      | · Gaskets and O-rings     |
| · Pilot air jet     | · Pilot outlet and bypass |
| · Needle jet holder | · Float                   |
| · Needle valve      | · Jet needle              |
| · Valve seat        |                           |

If any abnormal condition is found, wash the part clean. If damage or clogging is found, replace the part with a new one.

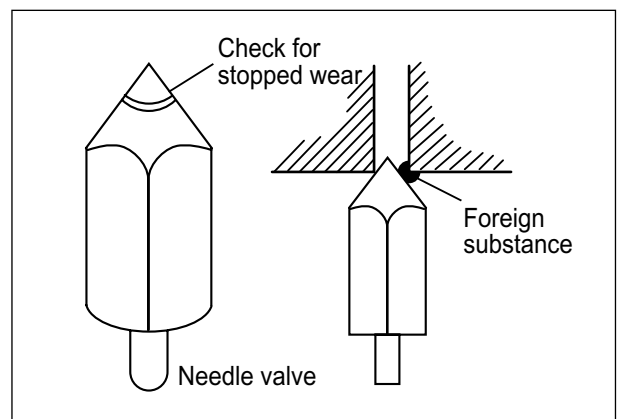

⊙ **CLEANING**

- Clean all jets by using compressed air.
- After cleaning, reassemble the carburetor with new seals and gaskets.

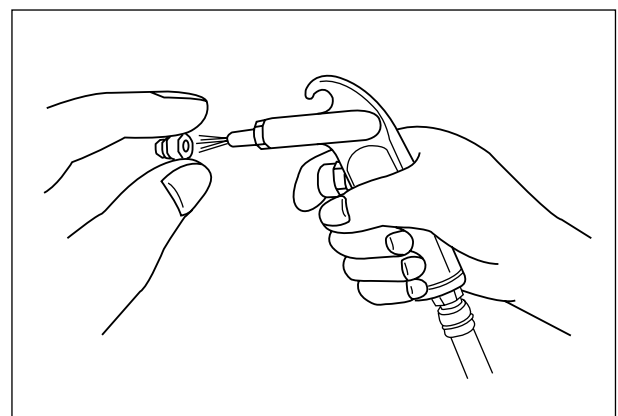

## 4-7 FUEL SYSTEM

### ⊙ FLOAT HEIGHT ADJUSTMENT

To check the float height, turn the carburetor upside down. Measure the float height **A** while the float arm is just contacting the needle valve using vernier calipers.

**Float height **A****

**7 mm (0.28 in)**



**Vernier calipers : 09900-20101**

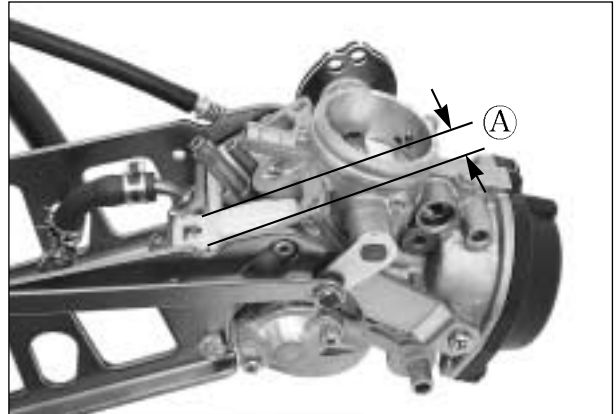

- Bend the float arm **①** as necessary to bring the height to the specified level.
- After adjustment, check the float height and the fuel level again.

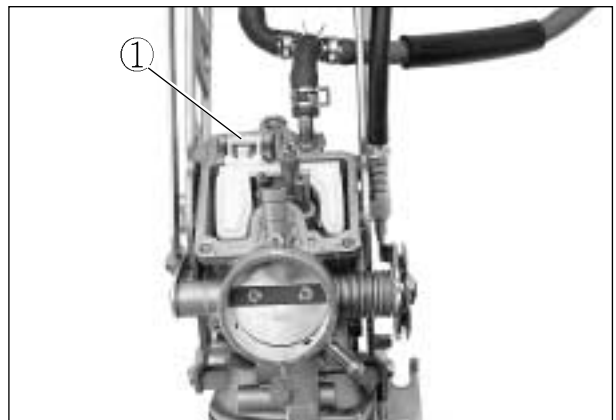

### ⊙ REASSEMBLY

Carburetor reassembly can be performed in the reverse order of disassembly. When reassembling, carefully observe the following instructions.

- After cleaning, reinstall the pilot screw to the original number of turn that is recorded during disassembly.
- Fit the seal rings securely to the float chamber and install the float chamber to the carburetor body.
- Install the three screw **②**.

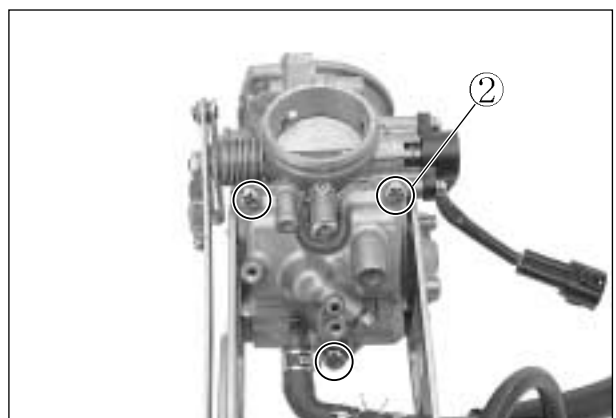
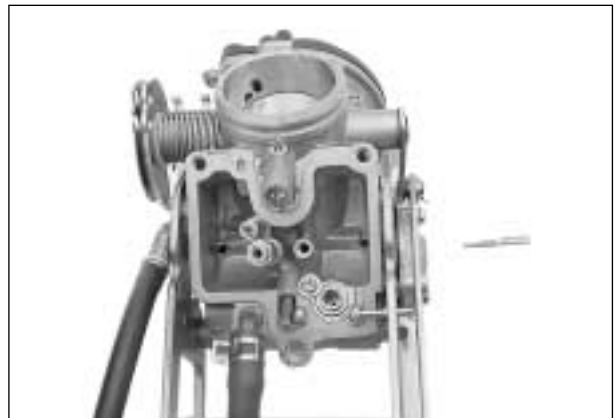



- Align the hole ① of the diaphragm with passage way on the carburetor body.

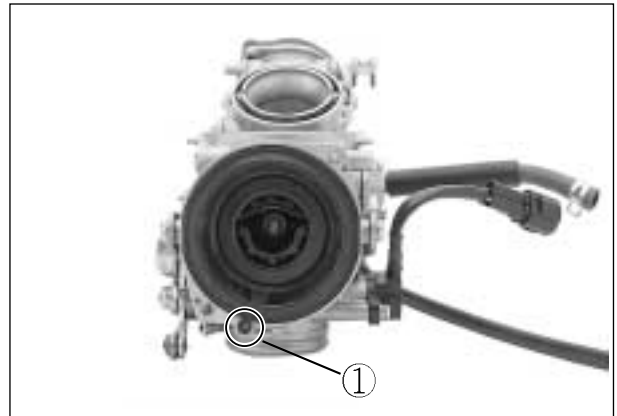

- Install the two screw ② and diaphragm cover ③.

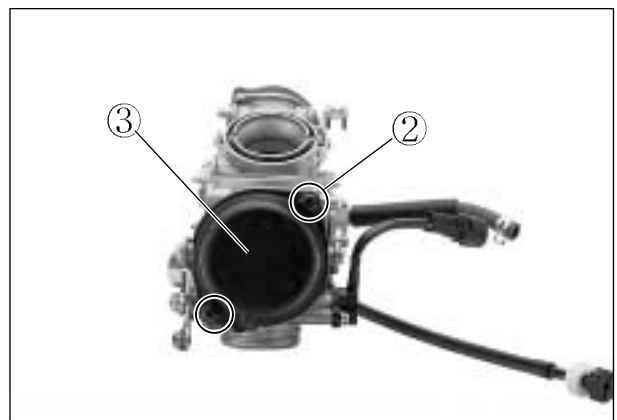

**⚠ CAUTION**

Never adjust "CO adjust screw" **A** of the carburetor. If adjust at discretion, have a bad influence upon output of the engine as the two carburetor is disharmonious.

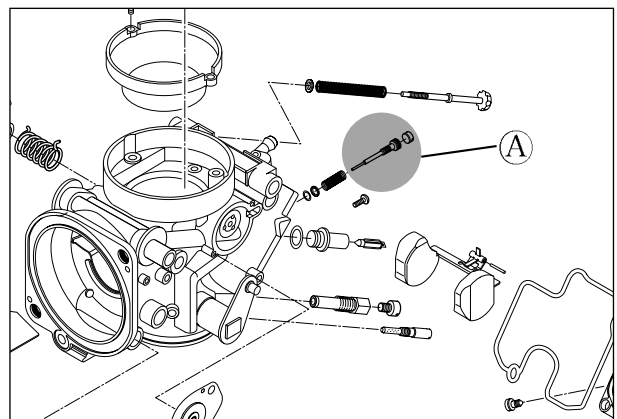

- After the assembly and installation on the engine have been completed, perform the following adjustment.  
Throttle cable adjustment. (Refer to page 2-8)  
Idle speed adjustment. (Refer to page 2-7)